

BRISTAN

This booklet covers product code:

PM SDIV C

Helpline
0330 026 6273

Bristan Group Limited

Birch Coppice Business Park, Dordon, Tamworth, Staffordshire B78 1SG

A Masco Company Website:

www.bristan.com

Telephone: 0330 026 6273

Email: enquire@bristan.com

At Bristan, we want to make things as easy as possible for our customers.

That's why we offer solid guarantees on all our products, effective from the date of purchase, to give you peace of mind.

To start your free guarantee, simply scan the QR code and Register your product.



Alternatively, visit www.bristan.com/register to register your product via a computer.

For full guarantee terms and conditions visit, www.bristan.com/guarantees

We Know & We Care

BRISTAN

Prism Diverter Valve

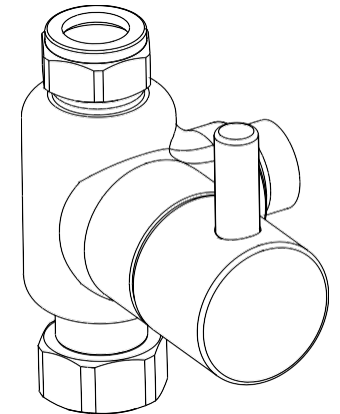

Fitting Instructions & Contents List

Please keep these instructions for future reference and request of replacement part

INSTALLATION

The diverter is designed to be fitted onto the G1/2" male outlet of an exposed shower valve to feed water to a rigid riser or handset and hose.

1. Identify all components, study diagram and check for completeness, particularly before arranging installation.
2. Install the shower valve (not supplied) as directed using the fitting instructions Supplied with that product.
3. Connect diverter (1) to shower valve via nut (2) using washer (3).
4. The vertical tube from the rigid (not supplied) will connect to the diverter via the compression nut (4) and olive (5) or G1/2" female nut with a flat washer or seal. (depending on the rigid riser's specification).
5. Finish fitting rigid riser as per the fitting instructions supplied with flat product.
6. Attach hose to diverter using small rubber washer and handset (not supplied).
7. Turn on shower and operate diverter in both positions using the diverter lever (a) To switch between the rigid riser and the handset. Check all joints and Connections for leaks.

MAINTENANCE

If either fitting begins to drip during operation:

1. Ensure shower control is in the 'off' position.
2. Unscrew lever (a) loosen grub screw (b), diverter head (c) and unscrew valve.
3. Carefully clean seating, rubber washer.
4. Replace valve and handle then test shower.
5. Contact our helpline if problem persists.

CONTENTS

1. Diverter	(x1)
2. Connecting Nut	(x1)
3. Washer	(x1)
4. Compression Nut	(x1)
5. Olive	(x1)

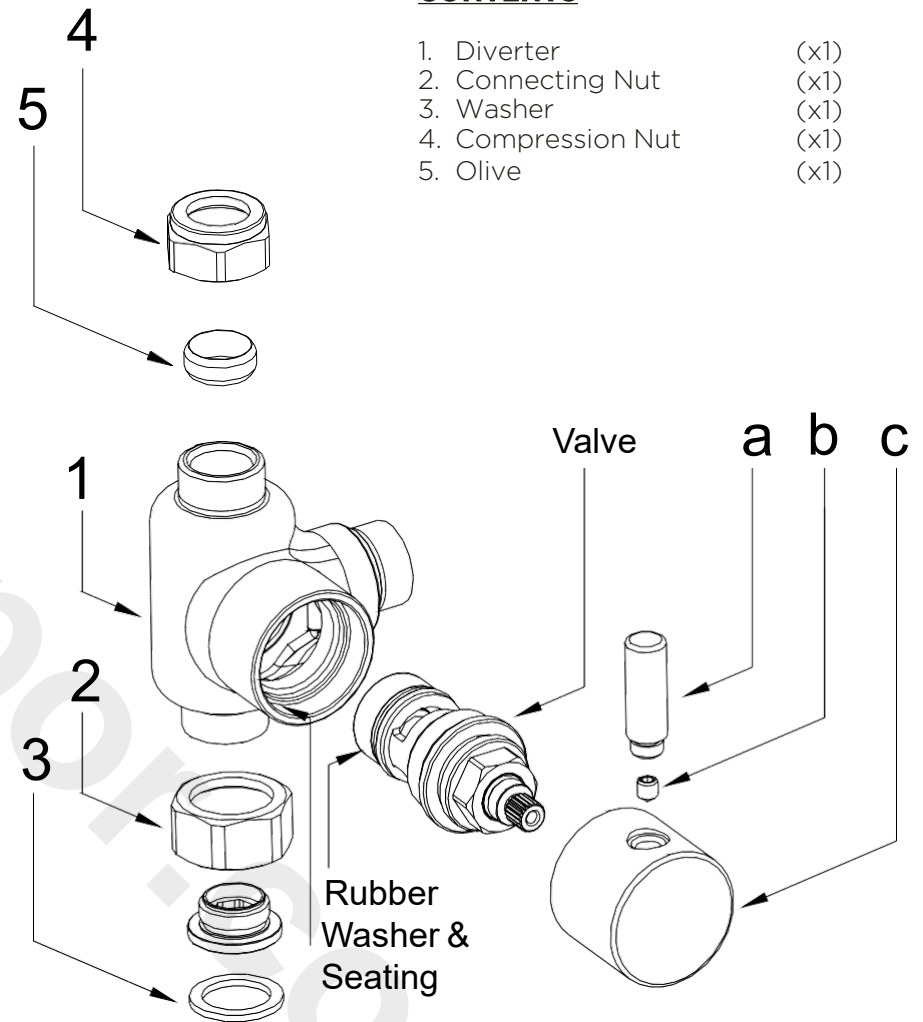

PLEASE NOTE:

In the unlikely event you find a part missing, please contact our Customer Service helpline on 0330 026 6273 for immediate dispatch of part